

Combi II

Colony Housing System for Layers/
Aviary for Layers

AVIARY FOR

LAYERS

www.farmerautomatic.de

- ✓ Feed chain
- ✓ EGGSAYER®
- ✓ ZINAL5® floor grates
- ✓ Manure belt rollers
- ✓ System lighting*
- ✓ Hot-dip galvanized components
- ✓ Self-rotating dust auger in the manure belt
- ✓ PA protective-coated floor grates*

Combi II Aviary and Colony Housing System for Layers

Combi II is a flexible housing system for layers. As the feed, water, nest and perch components can be arranged in different configurations, the system is perfect for use as an colony housing system or as an aviary system. With the feed troughs and egg belts on the inside, the complete system width of the Combi II counts as floor area.

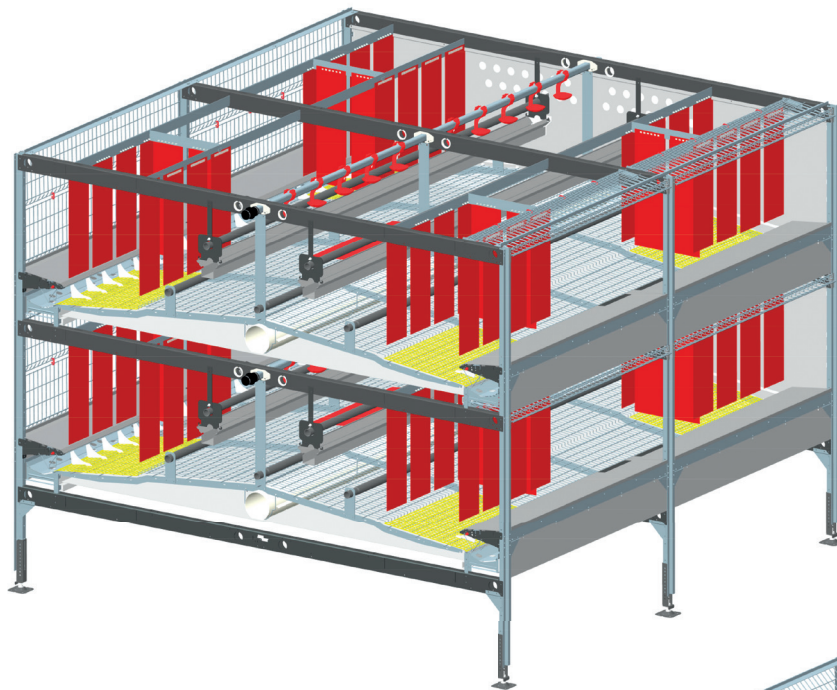

◀ Combi II example as enriched system for open or closed use.

Combi II example as enrichable system for closed use. ▶

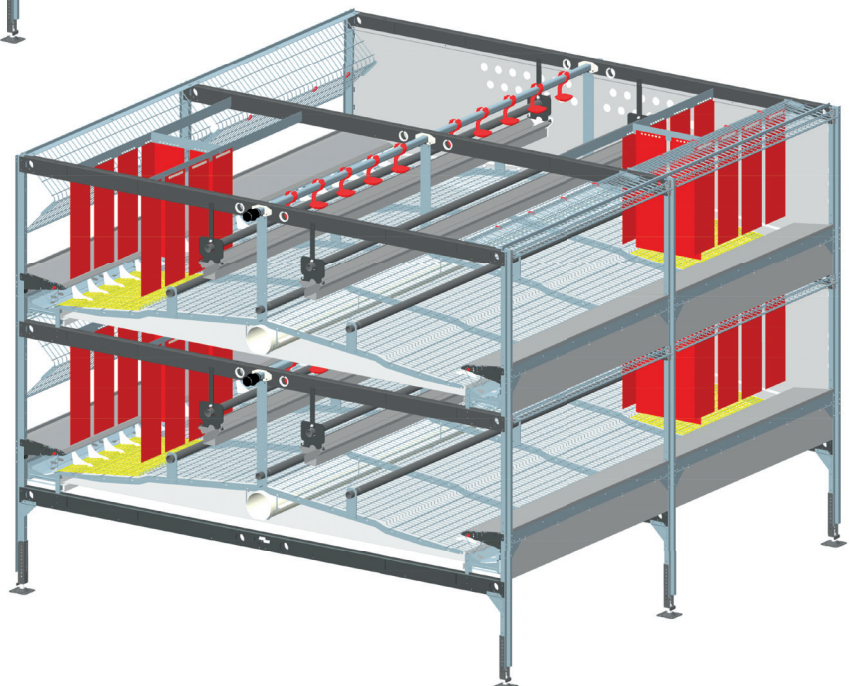

Combi II Features

Supply Unit Feed – Water – Nests

Each tier is equipped with feed lines, water lines, and nests, which guarantees optimum care. The livestock can easily reach all supply units on each tier. In addition, this ensures short routes and good nest accessibility so as to reduce system and floorlaid eggs. This increases the number of marketable eggs.

Compact Design with Same Equipment Level

The system's compact design is characterized by its very low overall height. In combination with identically equipped tiers this ensures very good visibility, thus supporting fast and easy monitoring of the livestock and the system. This reduces time and staff overheads.

Low System Height

The low system height in aviary systems allows for easy and quick monitoring of all tiers in the system. It also enables the installation of a second floor level above the system, which means that you can double the livestock count while complying with national legal provisions. This helps reduce staff costs and capital outlay.

Feed Chain

The unique Farmer Automatic feed chain, made of low-wear, durable steel, is gentle on the feed trough and guarantees a fast and even feed mix and distribution. The livestock thus has uniform access to fresh feed at any time.

EGGSAVER®

The patented EGGSAVER® ensures gentle rolling of the eggs onto the egg belt. This helps to prevent breakage and hair-line cracks, which heightens egg quality and system productivity.

Pro Swing Elevator

Depending on the system, the Farmer Automatic Pro Swing Elevator is capable of collecting eggs from any number of tiers. The elevator operation can be timed perfectly to match egg packer capacity. High volumes and time savings are thus possible. The Finger Elevator is available as an alternative.

ZINAL5® Floor Grates

The premium quality ZINAL5® standard coating on the Farmer Automatic floor grates is comprised of 95 % zinc and 5 % aluminum. ZINAL5® offers triplecorrosion protection for section

floors, including welded joints. This improves the longevity of the grate and improves the livestock's well-being by providing a more comfortable walking environment and reducing callus formation.

Manure Belt Rollers

Farmer Automatic's unique roller-guided manure belt system also supports low-wear operation in longer systems. Low rolling resistance means that less drive power is needed, which increases the service life of the manure belt.

PA Protective Coating on Floor Grates*

PA/polyamide-coated floor grates improve the livestock's well-being by creating a visually brighter environment, ensuring a pleasant walking experience on the grating and reducing callus formation. The virtually self-cleaning grates prevent manure from accumulating. Plastic-coated floor grates have a positive impact on livestock health.

Nests

The arrangement of the nests in the system is flexible. This reduces system and floor-laid eggs to a minimum. Narrow nest flaps on three to four sides of the nests ensure easy access to the nest. This results in a high level of nest acceptance, which can increase productivity. All nests are located immediately above the egg belt: this short distance means high quality eggs.

Foldable Doors*

When using this system as a colony housing system, extra-wide foldable doors can be fitted optionally. In an aviary these doors help the pullets grow accustomed to the system after relocation from the rearing system to the laying system. If the flock falls sick, it can be quarantined within the system. Medication can then be administered with optimum dosage.

Hot-dip Galvanized Components

Functionally critical system components are hot-dip galvanized for excellent corrosion protection and a long service life, which reduces maintenance and operating costs.

Stainless Steel Feet*

As an aviary, this system is equipped with high-quality stainless steel feet with a high level of corrosion resistance against litter and manure. This significantly extends the service life and durability of the system.

* optional equipment

Combi II	mm	inch
Section length	2400,00	94,49
Horizontal width/upright, external	2415,00	95,12
Tier height	710,00	27,95
Tier height with manure belt aeration tube	710,00	27,95
Min. floor clearance	450,00	17,72

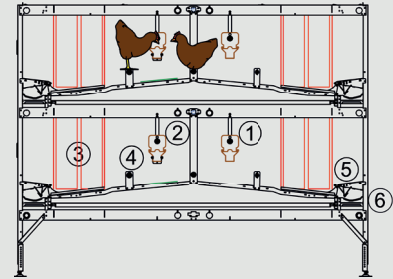

- ▲ 1. Feed trough
- 2. Drinking line
- 3. Nest
- 4. 5 perches per tier
- 5. Plastic fly-in platform
- 6. Egg belt

- ◀ Identical equipment on every tier ensures good visibility throughout the Combi II system.

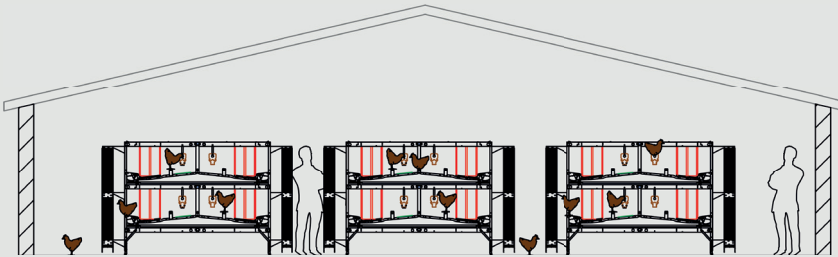

- ◀ 5 rows with 9 tiers and 2 second floors.



Farmer Automatic GmbH & Co. KG
Königstrasse 51
D-48366 Laer, Germany

T +49 2554 911 0
F +49 2554 911 89

info@farmerautomatic.de
www.farmerautomatic.de